

Site Layout 1:500

CHORLEY BOROUGH COUNCIL  
 TOWN AND COUNTRY PLANNING ACT 1990  
 19 JAN 2009 AB  
 THIS IS THE PLAN REFERRED TO IN  
 APPLICATION No. 09/1331

0m 10m 20m  
 Scale Bar 1:500

0m 25m 50m  
 Scale Bar 1:1250

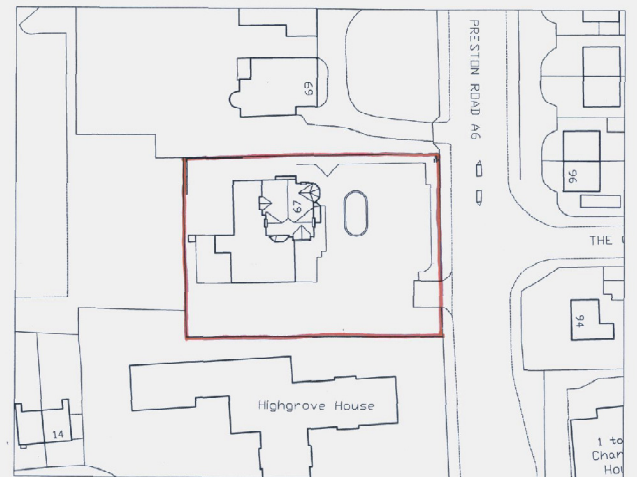
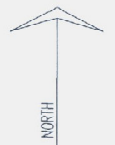

Location Plan 1:1250

CLIENT <b>W Marsden &amp; Sons</b>				
PROJECT <b>Proposed Residential Development at 67 Preston Road, Chorley</b>				
DRAWING TITLE <b>Existing Site Layout and Location Plan</b>				
DATE <b>16/01/09</b>	SCALE <b>1:500/1250</b>	DRAWN <b>JAL</b>	DRWG No. <b>08/147/E01</b>	REV
 <p>213 PRESTON ROAD WHITTLE LE WOODS CHORLEY LANCASHIRE PR6 7PS TEL: 01257 261555 FAX: 01257 267224 www.lmparchitects.co.uk</p> <p>© Copyright Lawson Magerison Practice Ltd.</p>				